

# EP-5955 ASSEMBLY INSTRUCTIONS

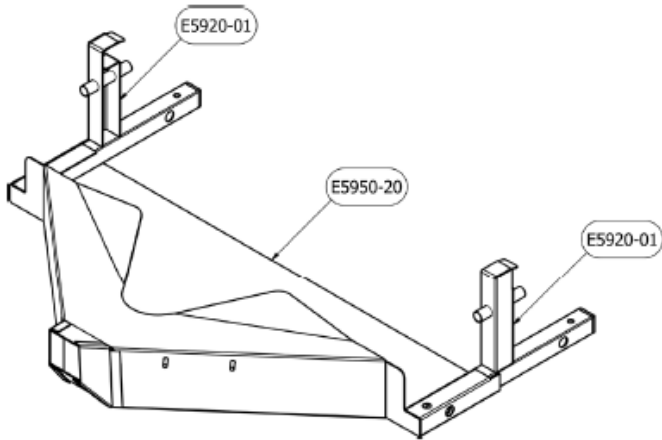

STEP# 1: Slide base support stands, (E5920-01) into the crumpler base. (E5950-20)

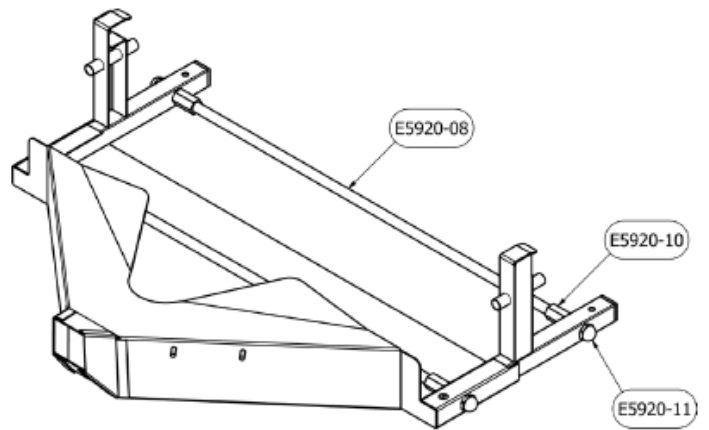

STEP# 2: Insert threaded rods, (E5920-08) through the base supports & crumpler base securing with threaded coupling nuts (E5920-10) & cap nuts (E5920-11).

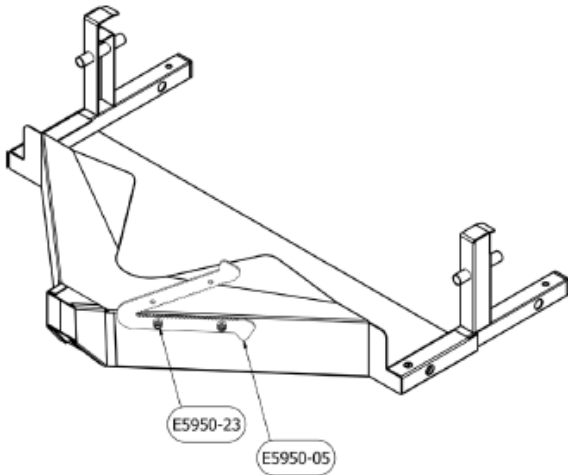

STEP# 3: Attach the "V-Cutter" (E5950-05) to the unit with two nylock nuts, (E5920-23).

STEP# 4: Remove the plastic core from the Kraft paper roll and slide the roll support rod, (E5920-06) & plastic roller tube, (E5920-12) through the Kraft paper roll. Lower it into position with the paper feeding out the bottom of the roll. Pull the paper through the opening in the crumpler. To cut the paper off the roll, loop it back and pull up on the "V" cutter's upper blade.

(The "V-Cutter" is reversible so that a fresh cutter blade is always available. Simply remove the two nuts, flip it over, re-tighten and continue cutting. When both sides are dull, order replacement Part#: E5950-05).

**(NOTE: If using light weight paper or if paper tears with pulling replace the Kraft paper plastic cores removed).**

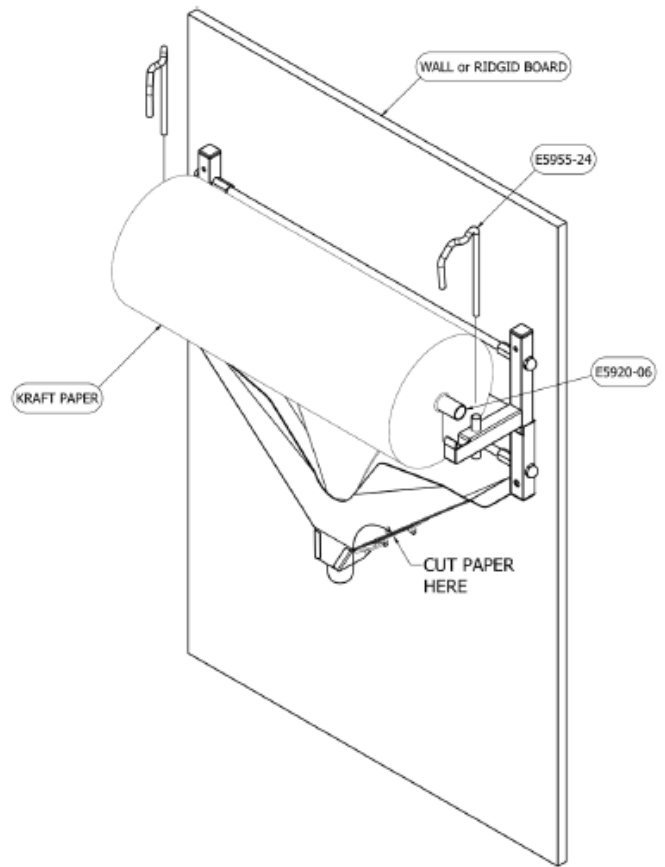

DO NOT OPERATE WITHOUT ROLL CONSTRAINT RODS, PART#: E5955-24 in place.